

Mercedes-Benz
powered

FREIGHTLINER

Grand Sport Ultra

TOURING COACH





It appeals to the muscle car lover in all of us.

Dynamax's Grand Sport has been an extraordinary motorhome ever since we created this antithesis of the boxy bus a few years ago. Our Grand Sport Ultra looks better, rides better, hauls better and *is* better than just about any other motorhome out there. Serviceability, safety and power are equally impressive.

And the best gets even better for 2007. Ultra exudes pure muscle with its monster Mercedes Benz® MBE 4000 engine and its 450-hp. Plus it offers an incredible twenty tons of towing power so you could tow a couple of those boxy buses we just mentioned.

Elegance and flair reside within every inch of Ultra's interior. Standard luxury features include stylish ultraleather upholstery, plenty of storage in rich hardwood wardrobes with cedar linings, an upgraded Bose® LS 38 DVD/CD with Surroundsound® and bigger 26-inch LCD TVs in the front and rear.



A

A. There is more roominess than ever as Ultra expands to 7-feet in height by 8-feet wide – spacious enough to accommodate your biggest friends and your own big ideas about entertaining.

B. The comfortable Flexsteel® EZ bed/sofa offers extra sleeping quarters – and extra living quarters when the hydraulic slide is activated.

C and D. The bathroom features deluxe Travertine® stone tile floors, a gorgeous Granite® lavatory with Nickel® accessories and a one-piece fiberglass shower and skylight. And there is lots of cabinet space for storage.

B



C



D





Perfection personified.

Grand Sport Ultra reaches a new level of luxury in 2007. Upgrades include a full queen size Comfort Select® Dual Control bed, superior grades of fabric throughout the motorhome and silhouette power shades that have two fabric facings to diffuse and beautify the light. Other improvements include an Amana® 15 cu. ft. residential-style refrigerator with stainless steel double doors, Granite® countertops in the bath and kitchen and fashionable stone tile floors — features you would find in the finest homes. Optional hardwood floors are also available.



A

A. The galley features gorgeous Granite® countertops and stone floors — features that are not only beautiful but also strong and rugged to last for years.



B

B. The handsome dinette features four comfortable freestanding chairs (two that fold) and a Granite® tabletop.



C

C. Power shades — elegant silhouette power shades soften harsh sunlight. Fully raised, they completely disappear in the headrail.

D. A GPS navigation system and CB radio are standard. (Now there are no excuses for being lost.)



D



Uncommon. Unmatched. Unbelievable.

The bedroom is so stunning you'll think you're dreaming. And maybe you are. It's so comfortable and very airy. And the large queen size bed still affords plenty of room to walk around. You'll find lots of storage inside the gorgeous cedar-lined wardrobes. Plus, there is a giant 26-inch LCD TV and a Fantastic® fan with temperature control and a rain sensor.



A



B

A. The spacious bedroom has plenty of storage with its beautiful hardwood, cedar-lined wardrobes.

B. The handy extra drawer in the galley gives you space to store more food items. The deluxe Amana® two-burner range with stylish black glass is the type of appliance you would find in a luxury home.

C. The built-in hamper features a beautiful hardwood sliding door and is a convenient storage place to hide away your laundry.

D. Ultra offers not one but two Sony® 26-inch LCD TVs. Now you can watch your favorite tv shows in the living area and in the bedroom.



D



EXTERIOR FEATURES

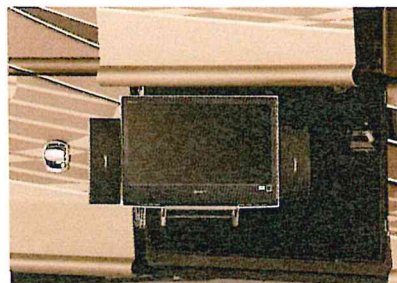

Incredible storage inside and out. Large exterior compartments have pantograph or side swing hinges for easier access. Plus, an exterior rear trunk adds even more storage. All storage compartments are lighted and have power locks.

Hydraulic leveling jacks. Four fully-automatic leveling jacks are standard on all Grand Sport Ultras.

The optional 40,000 lb. rugged rear hitch helps provide you with twenty tons of towing power.

An optional exterior TV provides extra entertainment for all of your outdoor parties.

"Ultra" Deep Gloss Paint Packages.

Grand Sport Ultra gets the grandest paint treatment — six clear coats of "Ultra" deep protection that will make your motorhome sparkle and shine. All five impressive packages are hip, clean and oh so contemporary.

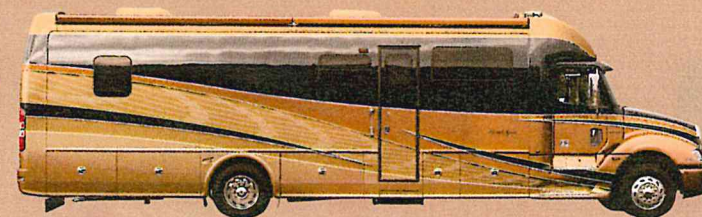

RAVENWOOD

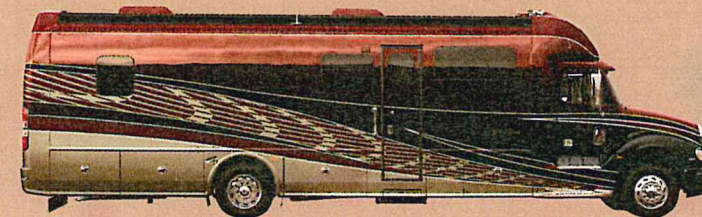

BORDEAUX

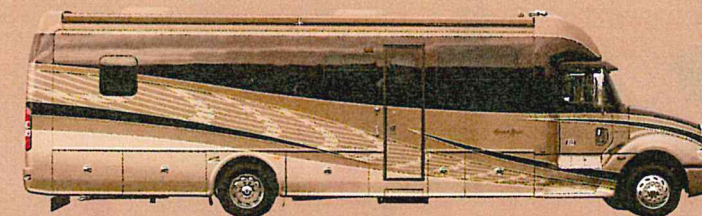

TAWNY RIDGE

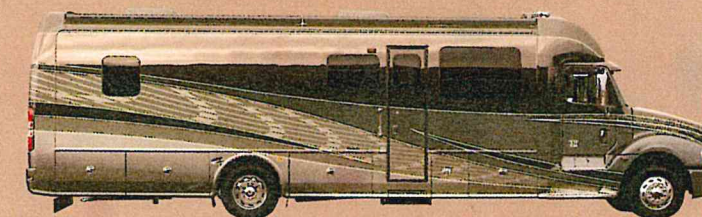

LATTE



BAY MOON

INTERIOR FEATURES

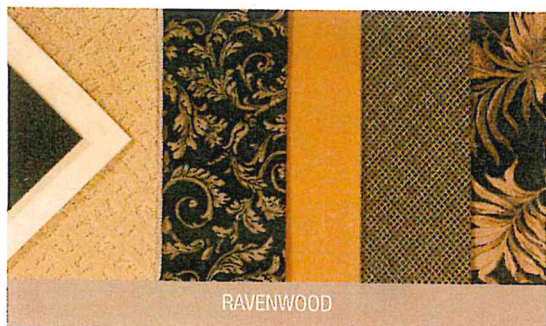

RAVENWOOD



BORDEAUX



TAWNY RIDGE

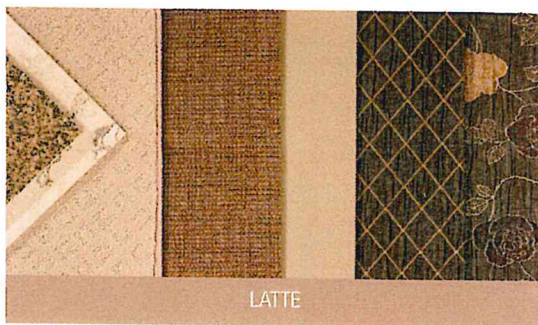

LATTE

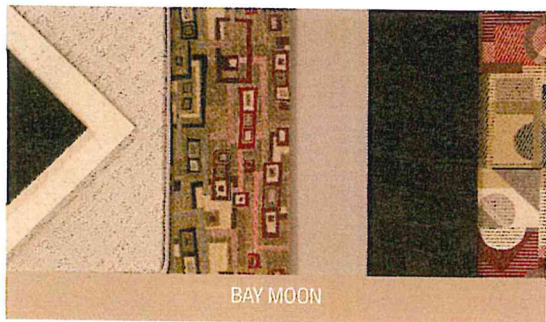

BAY MOON

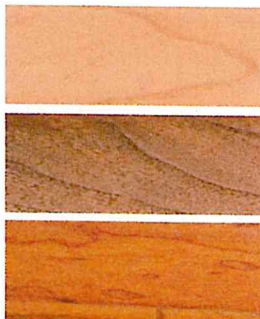

NATURAL MAPLE

STAINED CHERRY

NATURAL CHERRY

Elegant Interior Design Schemes.

Take a closer look at our exceptional fabrics, elegant hardwood cabinetry and premium ultraleather upholstery. All are crafted with discriminating style for long-lasting durability and beauty.

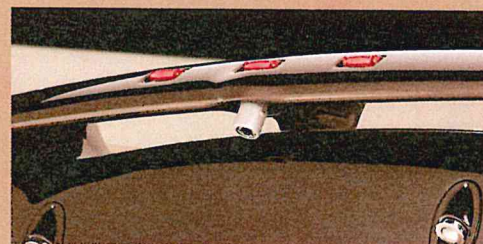

Cherry



Maple

The spacious cockpit features overhead storage for maps, sunglasses and more. Flexsteel® Bostrom ultraleather driver and passenger chairs adjust to your specific comfort with air and swivel pedestals.

Posi-Lock hardware creates a positive lock so no doors or drawers come open when the motorhome is moving.

Rear and side color backup cameras are standard. Cameras and monitor help make backing up safe and more secure. Plus they offer excellent picture quality.

Multiplex lighting switches let you control interior lighting. Dim or raise the lights, no matter where you are — switches are conveniently located throughout the coach.

A GPS navigation system and CB radio are standard equipment. And our Ultra even has a two spoke silver satin steering wheel wrapped in leather.

If you can't agree on which TV program to watch, Ultra offers two **26-inch LCD TVs**. One in the front and one in the rear bedroom.

Beautiful hardwood floors in maple or cherry are an optional feature that will give a warm, homey feel.

FLOORPLANS

Great design goes beyond just colors, fabrics and hardwoods. It also extends to designing smart, convenient floorplans. Ones that give you more storage space, more convenience and ample room to live your RV life. We applaud our designers because they have done just that.

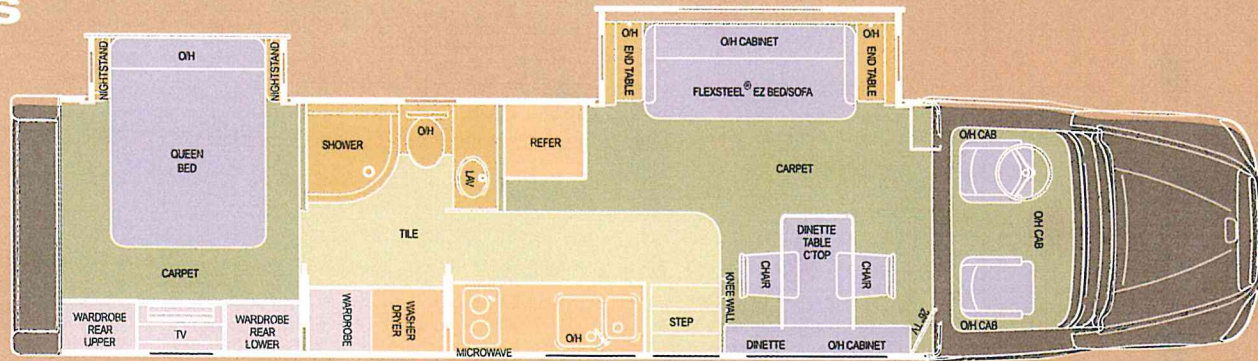

GC400UL

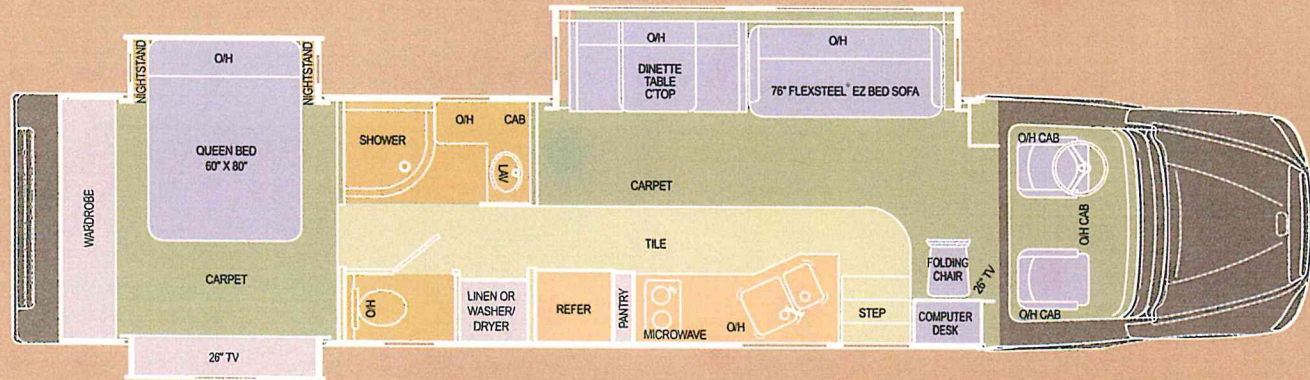

GC420UL

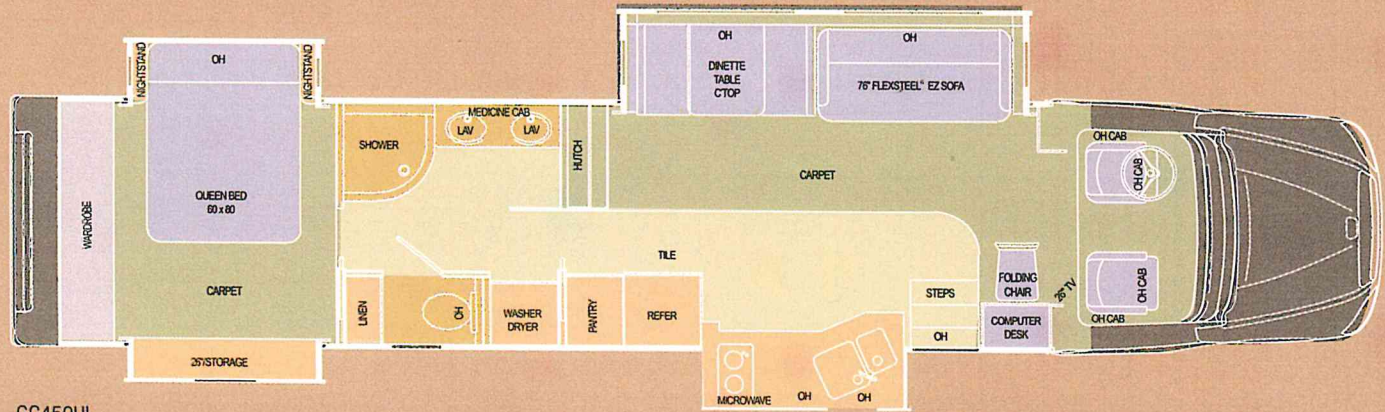

GC450UL

Engine: Freightliner® Columbia MBE 4000-450
 Horsepower: 450-hp @ 2000 RPM
 Torque: 1550 lb./ft. @ 1100 RPM
 Transmission: Six-speed Allison® 4000TRV auto push button
 Fuel tank: 140 gal.
 Brakes: Full air drum (ABS)
 Engine brake: Mercedes® off/low/high comp and exhaust
 Front axle: 14,000
 Rear axle: 23,000
 Suspension (front): Taperleaf 14,000-lb.
 Suspension (rear): Airliner 23,000-lb. (Granning tag 14,360-lb.—GC420UL and GC450UL)
 Rear axle ratio: 3.73 (3.90- GC450UL)
 Alternator: 270-amp
 Chassis batteries: (3) Alliance 1131 Group 31 12v maintenance free
 Battery disconnect: Below driver seat
 Block heater: 1500-watt/ 115-volt
 Aluminum wheels: Standard
 Tires: Michelin® XZE 275/80 R22.5 14-ply radial
 Auxiliary driving lights
 ICC lights

EXTERIOR FEATURES

Paint: Tawny Ridge (tan)/ Latte (taupe)/ Bay Moon (black & silver)/ Bordeaux (burgundy)/ Ravenwood (black & gold)
 Hydraulic jacks: Four-point fully-automatic leveling jacks
 Standard hitch: 14,000-lb. capacity
 Optional hitch: 40,000-lb. capacity
 Standard awning: Full length Zip Dee® awning curb side
 Optional awning: Full length Zip Dee® awning road side
 Window awnings: Built into Zip Dee® slide awnings
 Lighted grab handle
 External storage: Rear trunk/ aluminum doors and steel boxes—lighted/power locks
 Docking lights: Eight
 Air service lines
 Power step at entry door
 Exterior gas grill option (Forces LP system and LP detector)
 Optional AC/DC portable refrigerator/freezer

Décor: Tawny Ridge (tan)/Latte (taupe)/Bay Moon (black & silver)/Bordeaux (burgundy)/Ravenwood (black & gold)
 Flooring: Deluxe sculpted carpet (living room & bedroom)/ Travertine® stone tile (kitchen & bath)
 Flooring option: Hardwood
 Cabinets: Natural cherry/Stained cherry/Natural maple
 Deluxe, hidden cabinet hinges
 Posi-Lock door latches
 TV: 26" LCD with remote, cable-ready/fully-automatic digital satellite (in-motion optional)
 Deluxe residential style lighting
 Night floor lighting throughout
 Standard sound system: Bose® LS 38 DVD/Surroundsound® System
 Deluxe vinyl padded ceiling
 Deluxe vinyl padded wall
 Window shades: High style "Silhouette" tilt shade
 Valence: "Soft Touch" vinyl
 Standard sofa: Flexsteel® EZ Bed
 Optional sofa: Hide-A-Bed with air mattress
 Fans: Fantastic® vent fan with rain sensor and remote
 Safety features: LPG-leak detector, 12-volt carbon-monoxide detector, smoke detector, fire extinguisher

KITCHEN FEATURES

Countertop: Granite® top with backsplash, large double-bowl sink with cover
 Faucet: Nickel® single handle faucet with pull-out spray head
 Cooktop: Amana® electric deluxe, glass top two-burner- black (Forces LP system and LP detector two-burner gas optional)
 Amana® convection microwave- stainless steel
 Refrigerator: Amana® 15 cu. ft. electric double-door residential stainless steel (Dometic® 10 cu. ft. two-way with ice maker optional)
 Dinette: Four free-standing chairs (two folding) with Granite® table 120-volt outlet and phone jack (at dinette)
 Flooring: Travertine® stone tile (hardwood optional)

BATHROOM FEATURES

Countertop: Granite® lavatory top with integrated sink with Nickel® accessories
 Flooring: Travertine® stone tile (hardwood optional)
 Deluxe medicine cabinet
 One-piece fiberglass shower with skylight
 Toilet: Thetford® china
 Fantastic® vent fan with rain sensor
 Washer/dryer optional

BEDROOM FEATURES

Sleeping: Varies by floorplans and options
 Bedroom TV: 26" LCD
 Deluxe sculpted carpet
 Hardwood cedar-lined wardrobes
 Designer bedspread and pillows
 Night stand: Hardwood
 Fantastic® fan with temperature control and rain sensor

DRIVER COMPARTMENT

Back up camera: Color (two side rear view cameras standard)
 GPS navigation system
 Auxiliary 12-volt in-dash receptacle
 Engine air conditioning
 Cockpit driver chair: Flexsteel® ultraleather Bostrom—air/swivel pedestal
 Passenger chair: Flexsteel® ultraleather Bostrom—air/swivel pedestal
 Power driver and passenger windows
 Power locks on cab entry doors
 Intermittent windshield wipers
 Radio: AM/FM/CD
 Mirrors: Chrome heated/remote
 Steering wheel: VIP 18" two-spoke satin woodgrain, leather wrapped
 ICC lights
 Cruise control
 Roof mounted dual air horns
 Chassis battery disconnect
 Manual air-dump switch
 Full front cab sound insulation
 CB radio: Standard
 Dash-mounted air-restriction indicator
 Trailer brake hand control valve
 Overhead directional reading lights
 Dash instrumentation: Speedometer, engine oil temp, engine coolant temp, pyrometer rear axle temp, ammeter primary/secondary air pressure gauges, digital volt meter, brake application air gauge, transmission oil temp gauge, turbo air pressure gauge, tachometer
 Rear sonar: Optional
 Tire air pressure monitor: Optional

CONSTRUCTION HIGHLIGHTS

Floor: Heavy-duty 4" E-coated steel floor frame mounted on rubber isolators
 Walls: Sculptured, aerodynamic, fiberglass laminated sidewall panels
 Aluminum framing: Square-tube aluminum-framed sidewall with all wall penetrations box framed
 Windows: Panoramic bonded, tinted
 Roof: Square-tube aluminum-framed, one-piece radiused fiberglass
 Insulation (floor): R-11 solid block foam
 Insulation (sidewall & ceiling): R-8 solid block foam
 Cab: Steel safety cage surrounding transition from cab to coach
 Front transition aerodynamic fiberglass
 Molded-fiberglass rear-body cap
 Slide-outs: All hydraulic with side cross flow vent windows

UTILITIES

Coach batteries: Four (4) 4D AGM (Four (4) 8D AGM Optional)
 Inverter: 3000 watt power (Dual 3000 watt power inverter optional)
 Power cord: 50-amp with power reel
 Generator: 8.0 KW Powertech® (12.0 KW Powertech® Optional)
 Auto generator start system
 Multi-plex switching system
 Inside battery cut-off switch for coach
 Furnace: 50,000 BTU (12 gal.) Aqua-hot® deluxe heating and water system
 Thermostat: Single, digital thermostat for heating & cooling
 Optional heating systems: 20,000 and 40,000 LP gas furnace
 Cooling: Dual, low profile air conditioner—15,000 BTU with heat pumps
 Insulated ceiling air ducts with controllable air vents
 Water heater: 10-gal. Suburban® LP-gas
 Water pump: Multi-point water pump switching
 Heated water and holding tanks
 Fresh water hose and power reel

KEY DIMENSIONS	GC400UL	GC420UL	GC450UL
GVWR:	36,700 lb.	54,000 lb.	54,000 lb.
GCWR:	44,500 lb.	80,000 lb.	80,000 lb.
Overall Length:	39' 6"	42'	44' 11"
Exterior Width:	8' 6"	8' 6"	8' 6"
Wheelbase:	280"	320"	322"
Overall Exterior Height: (includes standard 15,000-BTU roof air conditioner)	12' 4"	12' 4"	12' 4"
Interior Height:	7'	7'	7'
Fuel Capacity:	140 gal.	140 gal.	140 gal.
Water Capacities:			
Fresh	110 gal.	110 gal.	110 gal.
Grey	52 gal.	52 gal.	52 gal.
Black	52 gal.	52 gal.	52 gal.
LPG Capacity:	opt. - no std	48 gal./160 lb.	48 gal./160 lb.



A manufacturer of luxury touring vehicles

2745 Northland Dr • P.O. Box 1948 • Elkhart IN 46515

888-295-7859

www.dynamaxcorp.com

Actual towing capacity is dependent on your particular loading and towing circumstances, which includes GVWR, GAWR and GCWR, as well as adequate trailer brakes. Please refer to the Owners Manual of your vehicle for further information. Floor plans, features and specifications of the Grand Sport Ultra are subject to change without notice.

CLUB MAX

Benefits to the Max

One of the really neat benefits of being a Dynamax owner is membership in the Dynamax's owners club. We call it Club Max. You'll call it a great way to enjoy your new motorhome, as you spend fun time with other owners. It's also a great way to travel and socialize, especially at the Dynamax Rally, held every year. In addition to rallies and special events, there are many other benefits, including *To The Max*, the official news magazine of Club Max; a roadside assistance program; FMCA Membership; KOA value card; a lost key program; and much more. And, of course, the biggest benefit is the network of friends you will soon develop. The camaraderie and spirit of the Dynamax community is a special part of the experience. To learn more, just go to www.myclubmax.com or enter through the Dynamax web site: www.dynamaxcorp.com.



DYNAMAX
CORPORATION

A manufacturer of luxury touring vehicles

2745 Northland Dr • P.O. Box 1948 • Elkhart IN 46515

888-295-7859

www.dynamaxcorp.com